

Bradley

TECHNICAL DATA

BRADPACK PRE-ASSEMBLED WASH CENTER

BR-110

WASHROOM ACCESSORIES
TECHNICAL DATA

BRADPACK® PRE-ASSEMBLED WASH CENTER

- Factory Assembled – Cuts Installation Costs
- Compact – Projects into Room Only 11-3/4"
- Recessed – Recesses in 4" Wall Construction
- Attractive – Coordinated Accessories – Concealed Plumbing
- Sanitary – Convenient Foot Control

All Bradpack Pre-Assembled Wash Centers are completely factory assembled and ready for installation and hookup to electrical and plumbing connections.

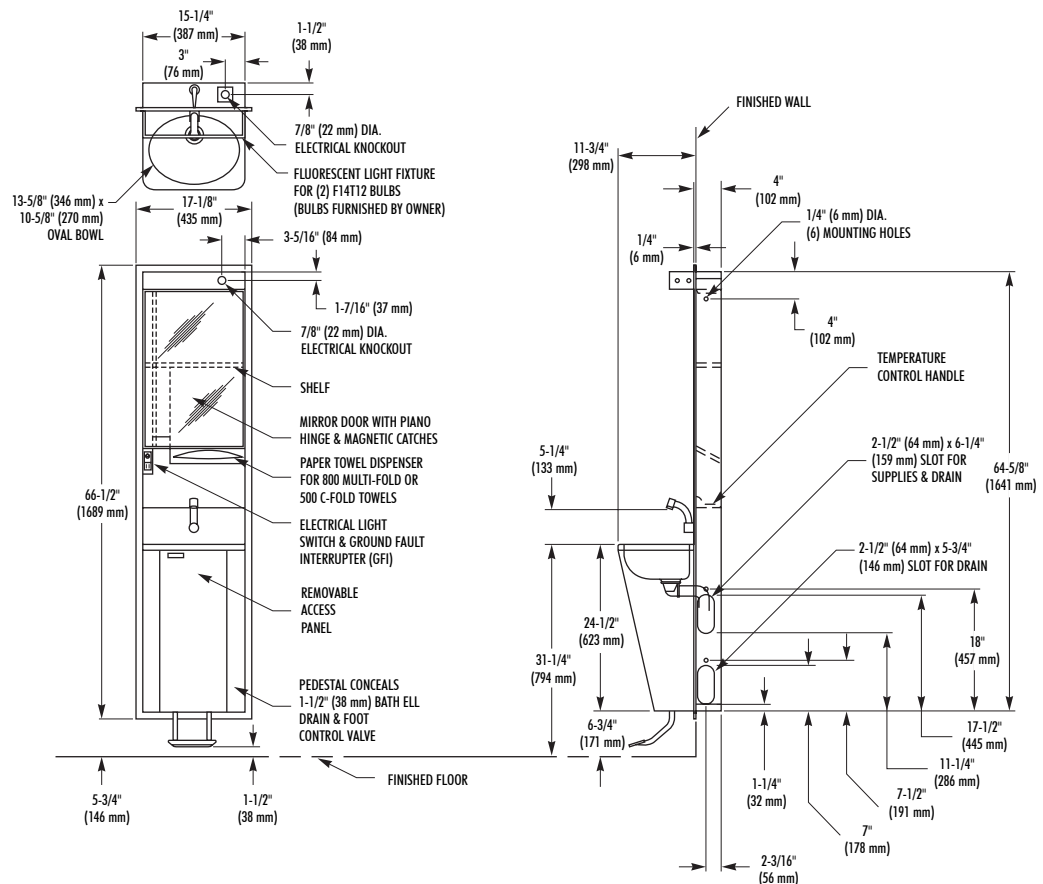

NOTE: 1. TRAP, STOPS AND SUPPLIES COMPLYING WITH LOCAL CODES TO BE FURNISHED BY CONTRACTOR.
2. DETAILED INSTALLATION INSTRUCTIONS ARE AVAILABLE ON REQUEST

WASHROOM ACCESSORIES
TECHNICAL DATA

BRADPACK® MODEL 110 PRE-ASSEMBLED WASH CENTER

CONSTRUCTION:

- **FLANGE** fabricated of type 304 (18-8), 22 gauge stainless steel with exposed surfaces in architectural satin finish. One piece seamless construction, 1" wide with 1/4" return.
- **CABINET** fabricated of type 304 (18-8), heavy gauge stainless steel, all spot welded construction. One full width shelf.
- **LIGHT FIXTURE** fabricated of type 304 (18-8), 22 gauge stainless steel. Accepts two 15", 14 watt fluorescent tube (not furnished by Bradley). Rapid start, sound rated ballast. Diffuser of non-yellowing acrylic. Pre-wired, tested and UL Listed for 115V A.C. operation. Toggle switch located below mirror door.
- **GROUND FAULT INTERRUPTER (GFI)** contains special low current leakage circuitry with reset button and safety check test button.
- **MIRROR DOOR** fabricated of type 304 (18-8), heavy gauge stainless steel with heavy duty full-length stainless steel piano hinge. Equipped with stainless steel spring-buffered rod stop and two magnetic door catches.
- **MIRROR** of first quality 1/4" polished plate glass, triple-silvered and electro-copper plated with baked enamel backing, guaranteed for 15 years against silver spoilage. Protected by shock absorbing waterproof filler. Glass removable if necessary.
- **TOWEL DISPENSER** fabricated of type 304 (18-8), 22 gauge stainless steel with rolled edge on dispenser opening.
- **BOWL** fabricated of type 304 (18-8), 18 gauge stainless steel with exposed surfaces in architectural satin finish. Oval design 13-5/8"L x 10-1/8"W x 5"D.
- **TRIM** of brass with heavy polished chrome plating. Gooseneck spout with aerated nozzle projects 5" above bowl. (Optional non-aerated spout available.) Free running 1-1/2" bath ell with stainless steel strainer. Trap and stops comply with local codes to be supplied by plumbing contractor.
- **PEDESTAL** fabricated of type 304 (18-8), 22 gauge stainless steel with exposed surfaces in architectural satin finish. Center panel removable for access to plumbing and operating mechanism. All panels replaceable.
- **FOOT PEDAL** fabricated of type 304 (18-8), 16 gauge stainless steel welded to two support brackets. Adjusts up to 1/2" for variations in finished floor.

CAPACITY:

Towel dispenser – 800 multi-fold or 500 C-fold paper towels.

OPERATION:

Foot pedal actuates flow of water and controls volume. Spring actuated mechanism operates self-closing mixing valve. Pedal swings up, out of the way for cleaning. Water temperature is controlled by lever on shelf above bowl, hot and cold settings indicated. Bradley Bradtrol mixing valve operating parts are replaceable as a cartridge unit.

INSTALLATION:

Requires rough wall opening 15-1/2"W x 65"H x 4"D. Top of opening 71-3/4" above finished floor. Secure to framing with mounting screws (included) at holes provided. Shim at screw points as required. Make final electrical and plumbing connections. Detailed installation instructions included with each shipment. Additional copies are available from your local Bradley Representative or by writing to Bradley Corporation, Washroom Accessories Division.

AVAILABLE CONFIGURATIONS:

Description	Suffix
<input type="checkbox"/> Built-in waste receptacle, 40 oz. barrier-free soap dispenser, cabinet lock	5EP
<input type="checkbox"/> Built-in waste receptacle, 40 oz. barrier-free soap dispenser, cabinet lock, ground fault interrupter	5EPU

GUIDE SPECIFICATION:

UL Listed pre-assembled wash center shall be one piece unit designed for recessed installation and be factory assembled, tested for proper operation and ready for connection to plumbing and electrical services. Unit shall consist of a stainless steel foot controlled lavatory with self-closing Bradley Bradtrol mixing valve for temperature and volume control, two tube fluorescent light fixture (fluorescent tubes not included), mirror, medicine cabinet with one full width shelf, multi-fold/C-fold towel dispenser with piano hinged door, and ground fault interrupter. Unit shall be fabricated of type 304 (18-8), 22 gauge stainless steel and 18 gauge bowl with exposed surfaces in architectural satin finish. Overall dimensions 17-1/8"W x 66-1/2"H with an 11-3/4" projection from finished wall surface. Trap and stops complying with local codes to be furnished by plumbing contractor. Recessed Pre-Assembled Wash Center shall be Bradley Bradpack Model 110.

- **Bradpack Wash Centers are UL listed.**
- **Bradley Bradpack foot operated wash centers are covered by U.S. Patent No. 3535715.**